

**Invasive Species Survey / Management Plan**

**Proposed Development Site**

**67 No. Social Housing Units,**

**Tyrrells Land**

**Stradbally Rd, Port Laois,**

**Co. Laois**

**REV:001**

## Contents

<b>Document &amp; Contact Information .....</b>	<b>3</b>
<b>1. Project Overview.....</b>	<b>4</b>
<b>2. Site Walkover Summary .....</b>	<b>5</b>
<b>3. Site Survey Photographs .....</b>	<b>6</b>
<b>4. Recommendations.....</b>	<b>10</b>

## Document & Contact Information

This document has been amended or otherwise reviewed since its last formal issue (shown by the issue status and date in the footer below) as follows:

Revision	Date	Issued for/Revision details	Revised by
001	31/08/2023	For Approval and issue	Adam Rice

### **ALL REVIEWS CARRIED OUT MUST BE DATED**

#### **Required Approvals**

	Name	Role	Signature	Date
Produced by	Adam Rice	Author	A. Rice	31/08/2023
Reviewed by	Stephen Donnelly	Senior Project Manager	S. Donnelly	31/08/2023

#### **Contact Details**

Project Manager	Email	Mobile Number	Office Number
Stephen Donnelly	stephen.donnelly@atg-group.co.uk	07355092651	028 7044 0380

Client Name	Site Address	Client Contact Details
Laois County Council	Tyrrells Land, Stradbally Road, Portlaoise, Co. Laois	Van Dijk Architects C/O Laois County Council +353 (0)429354466

## 1. Project Overview

Laois County Council enlisted the services of ATG to conduct a site survey and produce an Invasive Species Management Plan (ISMP) for an intended development site situated at Tyrrells Land, Stradbally Road, Co. Laois. The primary objective of the survey was to confirm the presence of any invasive species, delineate their distribution, and suggest potential remediation approaches. The contents of this document are based on the findings of ATG's comprehensive site inspection carried out on August 24th, 2023.

**Figure 1: Area to be surveyed**

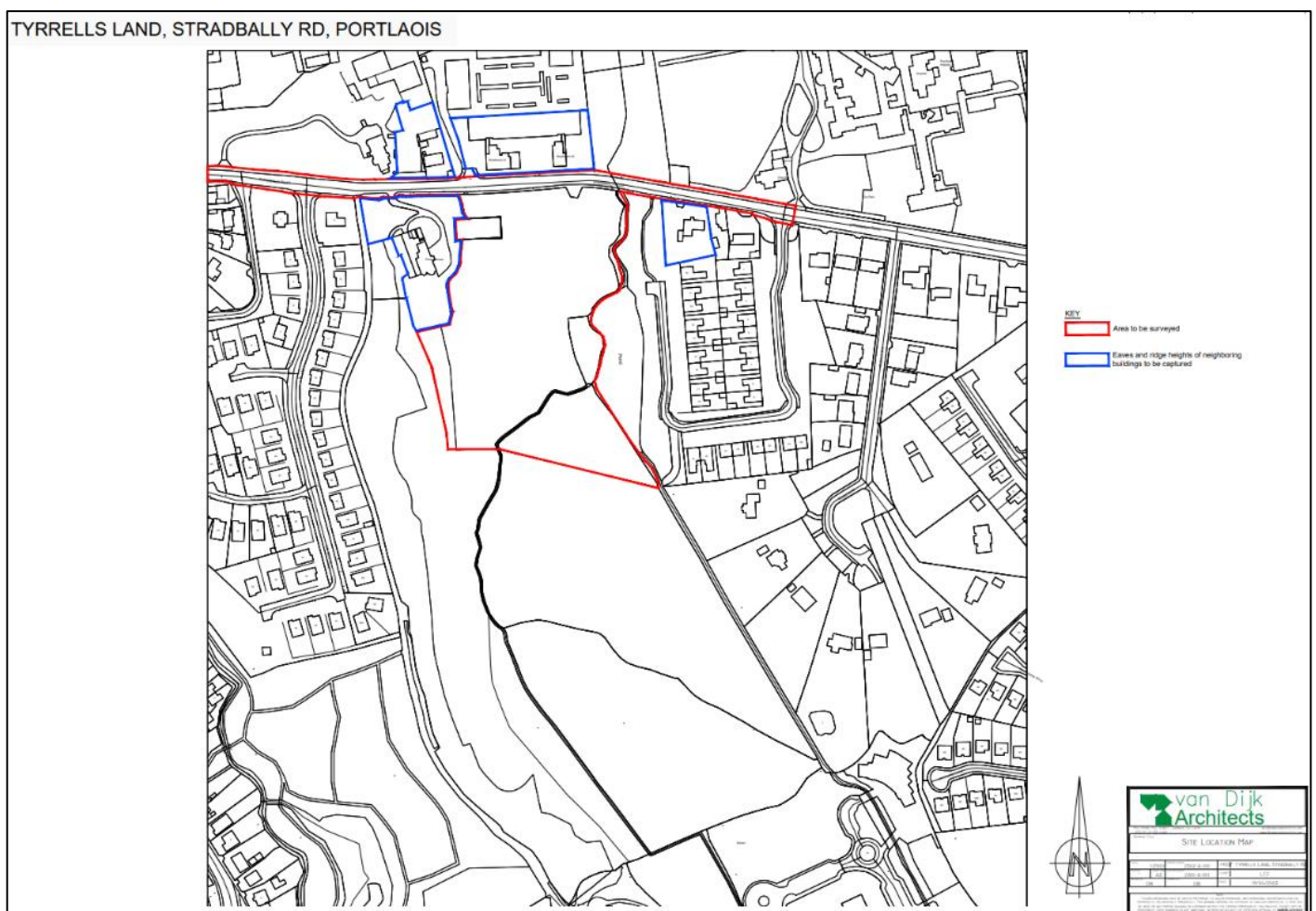

## 2. Site Survey Summary

The site in question is the proposed development of 67 social housing units at Tyrrells Land, Stradbally Road, Portlaoise, Co. Laois. The northern boundary is delineated by an existing stone wall and hedgerow, while the boundaries to Portrane House are marked by hedges and railings. Access to the greenfield site was facilitated from the Stradbally road, with overhead powerlines present along the N80 road boundary. The site exhibits substantial topographical variation, featuring rolling hills and mature trees, implying potential challenges and opportunities for invasive species management within this diverse landscape.

On August 24th, 2023, the ATG team conducted a comprehensive on-site inspection and assessment to identify the presence of invasive species. This includes but is not limited to Japanese Knotweed, Giant Hogweed, and Himalayan Balsam.

Throughout the course of the site survey, ATG's observations revealed the absence of any invasive species listed. None of the targeted species such as Japanese Knotweed, Giant Hogweed, or Himalayan Balsam were found to be growing within the site boundaries. To provide visual evidence of our findings, a collection of photographs captured during the survey has been included in the section below for reference and documentation.



### 3. Site survey Photographs















#### 4. Conclusion

The site survey conducted by ATG for the proposed development at Tyrrells Land, Stradbally Road, Co. Laois, carried out on August 24th, 2023, has revealed the absence of any invasive species listed, including Japanese Knotweed, Giant Hogweed, and Himalayan Balsam.

Consequently, based on the thorough survey findings, it is confirmed that no immediate or subsequent eradication and/or treatment works related to invasive species management are required for the development of the proposed housing units on the in question.